

# Functionality

# Comfort The



10 cm wheels for fast and easy moving of the chair in the desired direction



Removable armrests for easy access from wheel chair and better mobility of therapy chair in confined spaces



Individually adjustable armrest for optimal arm support and easy getting in and out



Central brake on both sides for quick fixation of all four wheels

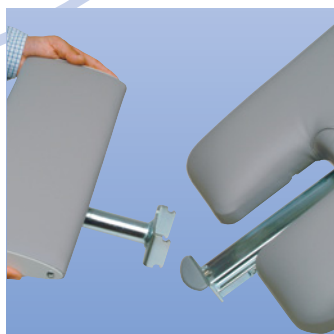

Adjustable and removable footrest to provide best comfort for small and tall patients



Easy to operate remote control for individual adjustment of sitting position by patient and nurse

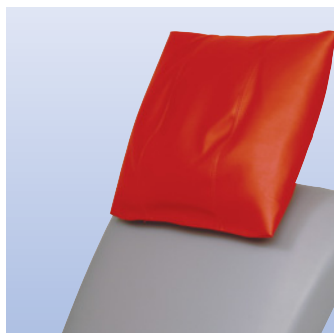

Large back section and height adjustable pillow to provide maximum comfort for large, tall and small patients

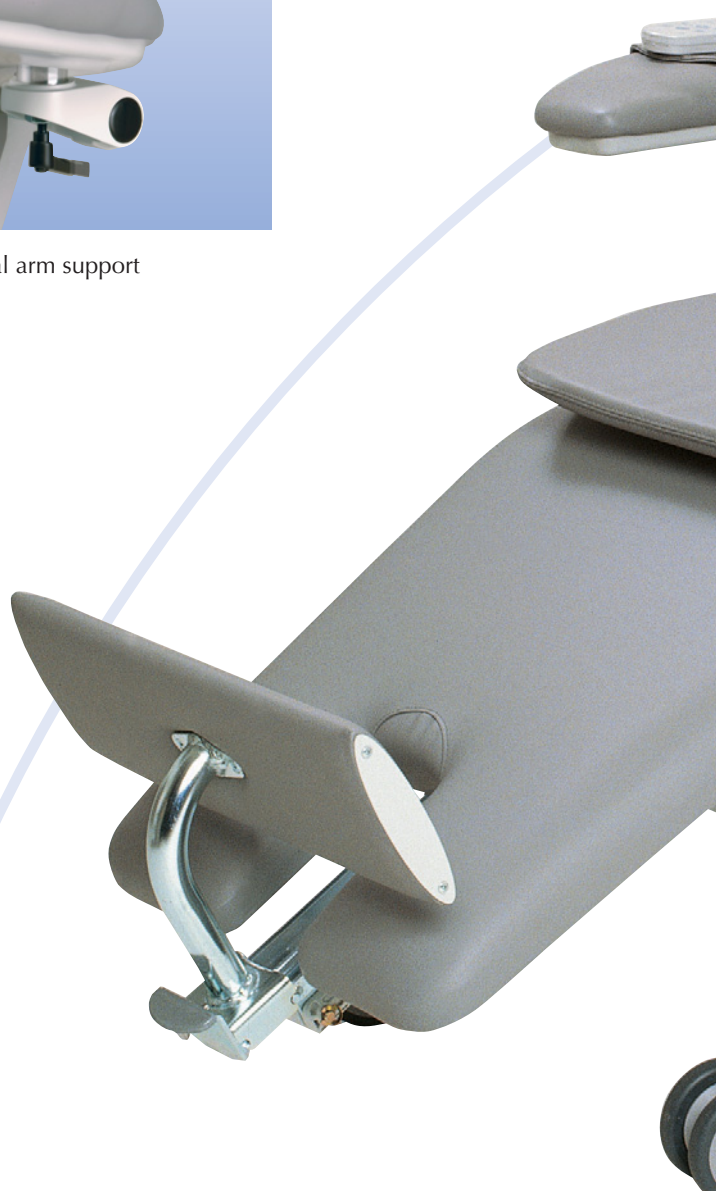

# Line – rapy chair



Easy access to all five IPX 4 protected motors and all plugs in compliance with EN 60601

## Accessories



A console table for blood mixing scales or other instruments can also be fitted to the chair



The additional reading lamp connected to a back handle which allows moving the chair from behind

# Safety



Switch on/off button for disconnecting the chair from the power supply in compliance with EN 60601

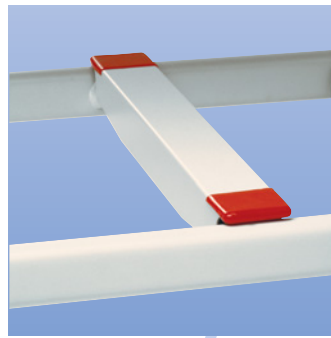

Emergency foot pedal allows hands free operation in an emergency case and also prevents unintended misuse by the patient



Equipotential bonding in compliance with EN 60601 to give patient on dialysis with catheters the necessary protection



High speed Trendelenburg position allows very fast reaction in case of shock and immediate initiation of emergency measures



Newly developed construction ensures high stability in horizontal position necessary in different emergency cases

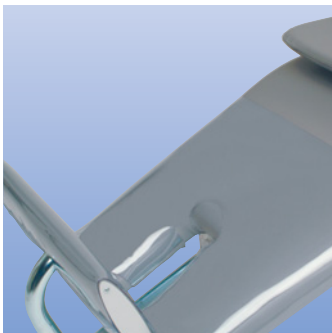

Plastic protector for leg and footrest to protect most sensible parts of the chair against dirt



Infusion pole can be fitted to specially designed infusion pole receptacle



Bi colour design with modern look allows colour combination fitting to the furnishing of the working environment



A paper roll holder for a roll of 50 cm width paper can be mounted on the back handle of the chair

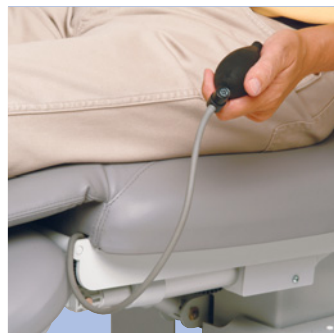





Four different upholsteries of the seat (standard foam, metall spring, visco-elastic foam) are available on request including an adjustable air cushion.

Standard colour:

Chrom grey 

Special colours:

- Feuer 
- Atoll 
- Royal 
- Karneol 
- Tuerkis 
- Apricot 

Additional colours upon request

# ComfortLine:

## A new definition of design, functionality and safety

An entirely new chair concept has been developed to make the time of dialysis treatment as comfortable as possible for the patient and to give the nursing staff the best possible access to the patient even in critical situations.

Modern design, materials of high quality and a first class finishing of upholstery, mechanical and electronic parts underline the high standard of this therapy chair. **Different colour combinations** make the chair fit perfectly into the desired environment. **Four different upholstery technologies** provide the best individual comfort for every patients need. The range of upholsteries includes standard foam, spring core, visco-elastic foam and adjustable air cushion. The ergonomically shaped upholstery adapts in an optimal way to the patients body and the water resistant surfaces allow **easy cleaning**.

**Five motors** make the chair adjustable into all positions desired by the patient and by the nursing staff. Multifunctional arm rests and an adjustable foot and head section make the long term dialysis treatment more comfortable for the patient.

The idea of the ComfortLine is not only to provide maximum comfort but also to allow nurses and physicians to **react in critical situations**. The newly developed construction of the ComfortLine provides very **high stability whilst in horizontal position**. The powerful motor system allows the **shifting to Trendelenburg position at high speed**. The **activation of the Trendelenburg position by foot pedal** ensures that immediate measures can be initiated without having to press emergency button by hand first.

Taking into consideration also the need of a new generation of patients the width and length of the chair as well as the **safe maximum load of 180 kg** is designed to allow a comfortable treatment also to bigger persons. An **height adjustable pillow** provides optimal head support. The **telescopic footrest** can be adjusted individually to give very small up to very tall persons a secure feeling during treatment.

**The multifunctional armrest** is designed to ease the access to the patient and to support the arm. The **armrest moves synchronously** when chair position is adjusted and can be lifted upwards for better entry and exit of the chair. To facilitate getting in and out for patients in wheel chairs the **armrest can be removed**.

ComfortLine gives you the possibility to combine comfort, safety and functionality to meet individual needs and desires.



# Technical data

## Dimensions

Seat section width  
Chair width, incl. arm rests  
Total length  
Total weight

60 cm

90 cm

190 cm

90 kg

## Adjustment features

Back section  
Seat section  
Leg section  
Foot rest  
Height

75°–0°

25°–0°

0°–40°

20 cm

60 cm–80 cm

## Safety

Safe maximum load  
Angle of Trendelenburg position  
Time for Trendelenburg position

180 kg

- 12°

10 sec

## Electrical specifications

Power supply/voltage  
On demand  
Wattage  
Max. charging rate  
Protection class  
Protection category  
In compliance with

230 V/50 Hz

110 V/50 Hz

170 VA

8 A

2

IPX 4

EN 60601



Bionic Medizintechnik GmbH ... a JMS-corporation Š Max-Planck-StraÙe 21 Š D-61381 Friedrichsdorf/Germany  
Phone +49 (0)61 72-7576-0 Š Fax +49 (0)61 72-7576-10 Š info@bionic-jms.com Š www.bionic-jms.com

# ComfortLine – Therapy chair

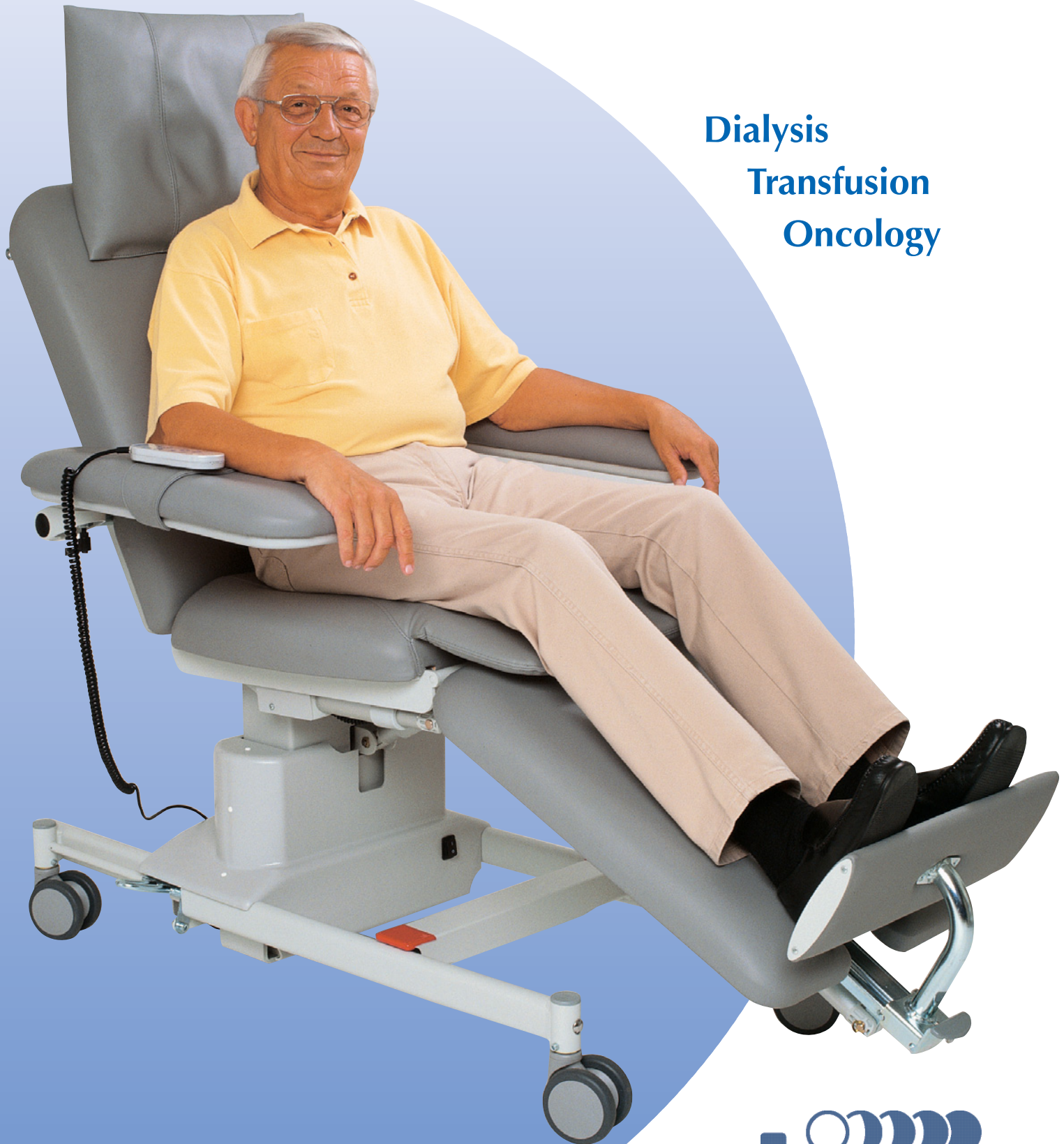

Dialysis  
Transfusion  
Oncology

  
bionic